



- **Standard Analog telephone/ SIP telephone**
- **Robust housing, constructed of cold rolled steel**
- **Vandal resistant metal button**
- **Hands free operation**
- **On wall mounting, simple installation**
- **Weather proof protection: up to IP55**
- **Dual button autodial for emergency call**
- **External power supply or PoE (SIP)**
- **RJ45 Port for SIP connection**
- **CE, FCC compliant**

The Handset Telephone is designed to meet the needs of client who experience loss through vandalism. Ideal for parking lots, prisons, railway/metro platforms, hospitals, police stations, ATM machines, stadiums, outside building etc.

Housed in cold rolled steel box and manufactured to a high standard, these telephones offer increased resistance to vandalism, and ensure that the primary function of communications is maintained at all times.

Extremely easy to install. The cable entrance is on the back of the phone to prevent from artificial damage, while the keypad is weather and vandal resistant.

Standard Analogue

As a standard analogue telephone, this unit provides basic telephone functions and can be connected to any standard two-wire telephone line, including analogue PABX lines and PSTN.

SIP-VoIP TECHNICAL SPECIFICATIONS

Adapter Input:

100-240VAC 50~60Hz Output:5V/1A

Port:

WAN: 10/100Base- T RJ-45 for LAN, Auto MDIX

LAN: 10/100Base- T RJ-45 for PC, Auto MDIX

Power Consumption:

Idle:1.5W/ Active:1.8W

Main Chip:

Broadcom

Voice Features

- Support 2 lines SIP, SIP 2.0 (RFC3261)
- Codec: G.711A/u, G.7231 high/low, G.729, G.722,G.726
- Echo cancellation: Support G.168 and hand-free can support 96ms
- Supports full duplex.
- SIP support SIP domain,SIP authentication(none, basic,MD5),DNS name of server, peer to peer
- SIP support 2 servers, user can through each server to calling in and out

Network Features

- WAN/LAN: support Bridge mode
- Support PPPoE for xDSL
- support VLAN
- Support Stun penetration
- Support DHCP get IP on WAN port

TECHNICAL SPECIFICATIONS

Casing Material

Cold rolled steel body

Colors

RED, YELLOW, GREY

Handset Material

No handset

Keypad

No keypad

Temperature

Operating: -30°C to +70°C

Storing: -40°C to +75°C

Weather Resistance

IP55

Ringling Tone

Shrill warble tone 80 dBA @ 1 metre typical

Hook switch

Electronic / magnetic with no visible moving parts

M.T.B.F.

Calculated to have an M.T.B.F. in excess of 50,000 hours using

Weight

Up to 1 kg depending on option

ANALOGUE

Dialing

MF (tone)

Power supply

Drawn from telephone line

Lightning / Transients

Protection to ITU-T k.21 enhanced levels

Programming

Can be programmed as an auto-dial phone

GSM/3G TECHNICAL SPECIFICATIONS

Standard SIM card

Working Frequency Range:

GSM: GSM850/900/1800/1900MHz

3G: WCDMA850/1900/2100MHz

GSM850/900/1800/1900MHz

Adapter Input:

7.4 V-12V DC

Power Consumption:

Idle current: 75mA

Off hook current: 160mA

Installation

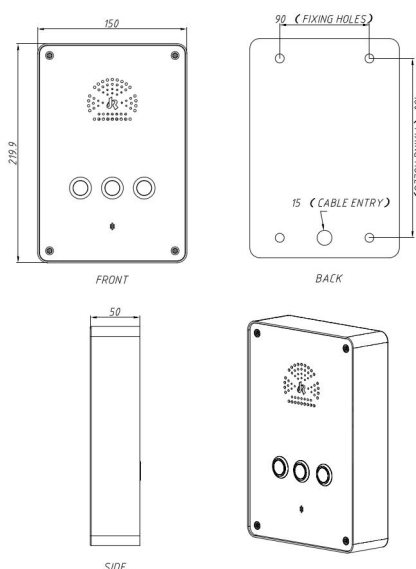

PPROVALS



This mark indicates compliance with the:
Radio & Telecommunications Terminal Equipment
Directive
2004/108/EC



This mark indicates compliance with the:
FCC Part 15 Subpart B Class B

PACKAGE

unit size: 170 *130 *60(mm)

Carton size:200 *140 *100(mm)

Packaging materials: pearl cotton, carton

Net weight: 0.8KG

Gross weight: 1KG